

# Cheriton Farm awaits you Lot 17 Rule Drive, Bundamba

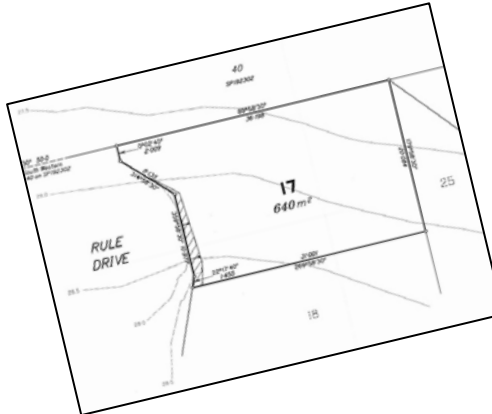

Perfectly situated to the new Ipswich Centre with all its amenities, yet only 20-25 minutes to Brisbane CBD, makes this ideal. This is the cheapest land available close to all these amenities.

## Ridgewood 200

**Fantastic Investment or first Home Opportunity  
Plans approved ready for construction**

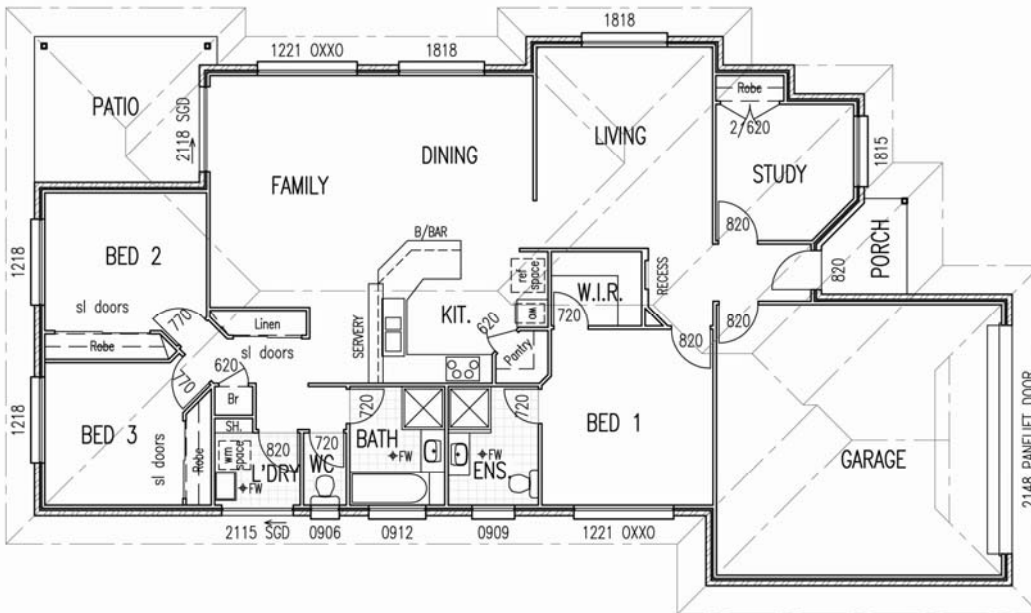

BUILDING AREA	
LIVING:	148
GARAGE:	38
PORCH:	3.2
PATIO:	11.6
<b>TOTAL:</b>	<b>200.8 m<sup>2</sup></b>

**Full turn key House & Land package** within walking distance of Tafe College and Train Station

Land price:	\$170,000	Land size:	640 m <sup>2</sup>
House prices:	\$217,000	House size:	200.8m <sup>2</sup>
Complete:	\$387,000	House design:	Ridgewood 200



Pricing includes full standard Cool Attitude Homes Inclusions as per estate covenants